



## AVC-NAB81F28 **AI**

NDAA  
COMPLIANT | CE | FC

8MP SMART DEFENDER BULLET NETWORK CAMERA

### DIMENSIONS

Unit : inch(mm)

### OVERVIEW

- 8MP (3840x2160) @15fps H.265/ H.254
- Full Color Smart Defender Camera
- 2.8mm Fixed Lens (F1.0)
- 3D DNR, D-WDR
- White Light LED / Strobe (Blue & Red) Light
- Built-in MIC / Speaker
- Built-in Micro SD card slot (up to 512GB)
- AI Feature : Pedestrian & Vehicle Detection, Intrusion Detection, Tripwire Counting, Loitering Detection, Region Entrance / Exiting Detection
- IP67 ingress protection
- PoE / DC12V Power supply
- Support remote monitoring by AVYCON ONE (Mobile APP) and AVYCON CMSONE (CMS)

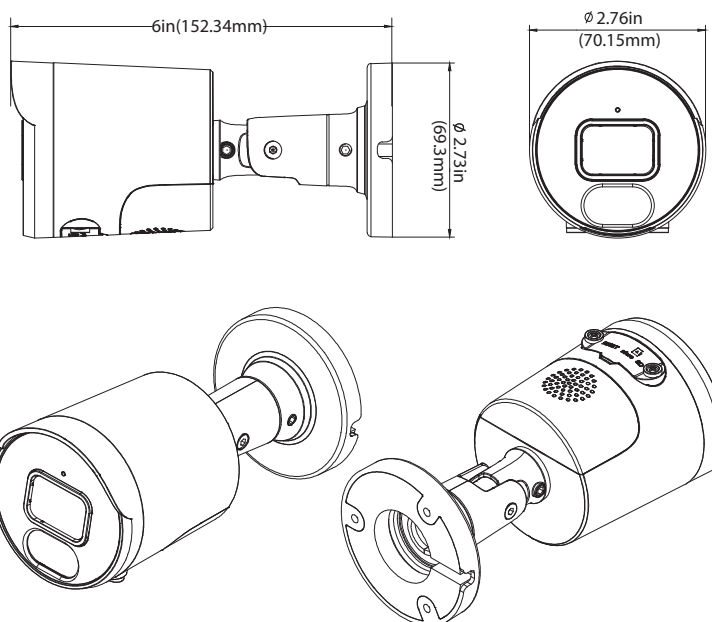

### OPTIONAL ACCESSORIES



AVM-JB-B-AD1  
JUNCTION BOX



AVM-CRM-A1  
CORNER



AVM-POM-A1  
POLE

SPECIFICATIONS

VIDEO	
Imaging Device	1/2.7"
Effective Pixels	8MP 3840(H) × 2160(V)
Scanning System	Progressive CMOS
Min. Illumination	Color 0.007 Lux @ (F1.0, AGC ON); B/W 0 lux @ IR ON
LENS TYPE	
Focal Length (Zoom Ratio)	2.8mm Fixed
Max. Aperture Ratio	F No. 1.0
Angular Field of View	Horizontal:110°, Vertical: 58°, Diagonal: 133°
Min. Object Distance	6.56ft(2m)
Lens Type	Fixed(M12)
OPERATIONAL	
IR LED	1
White Light	2
Red Blue Light	2 (1 Red & 1 Blue)
IR Viewable Length	Up to 82ft(25m)
White Light Viewable Length	Up to 65ft(20m)
Type of Complementary Light	Default white light, switchable infrared light
Motion Detection	Off/On (8 Level)
Wide Dynamic Range	DWDR
Digital Noise Reduction	3D DNR
Day & Night	Full Color (default) / Day&Night / Smart Illumination
White Balance	Auto/Manual
Electronic Shutter Speed	1/5 ~ 1/20000s
Edge Storage	Micro SD/SDHC/SDXC Slot (512GB)
Alarm I/O	N/A
Audio I/O	Built-in MIC / Built-in Speaker
Hardware Reset	Yes
Smart Feature	Pedestrian & Vehicle Detection (SMD), Intrusion Detection (ID), Tripwire Counting (TC), Loitering Detection (LD), Region Entrance / Exiting Detection
NETWORK	
Ethernet	RJ45(10/100BASE-T)
Video Compression Format	H.265/H.264
Resolution	Main Stream@15fps: 8MP(3840x2160) Sub Stream@15fps: 1080P(1920x1080)
Video Quality Adjustment	512Kbps ~ 6Mbps
Bitrate Control Method	CBR/VBR
IP	IPv4
Protocol	TCP/IP, HTTP, DHCP, DNS, DDNS, RTP/RTSP, SMTP, NTP, HTTPS
Application Programming Interface	ONVIF, REST API
Web Viewer	IE10,11
ENVIRONMENTAL	
Operating Conditions	-31~140F(-35~+60°C)/less than ≤ 90% RH
Ingress Protection	IP67
ELECTRICAL	
Input Voltage / Current	D12V/PoE(IEEE802.3af)
Power Consumption	DC12V : max 7.2W ; PoE (48V): max 8.4W
MECHANICAL	
Material	Metal
Dimensions (HxWxD)	Ø2.76 X 6in (Ø70.15 X 152.3mm)
Weight	0.63lb(282g)